

# Industrial Lands

Business Growth. Local Jobs. Thriving Economy.

Industrial lands support the places where things are produced, distributed, or repaired. They are essential to creating a complete and functioning community, along with shops, homes, schools, parks, farms, and conservation lands.

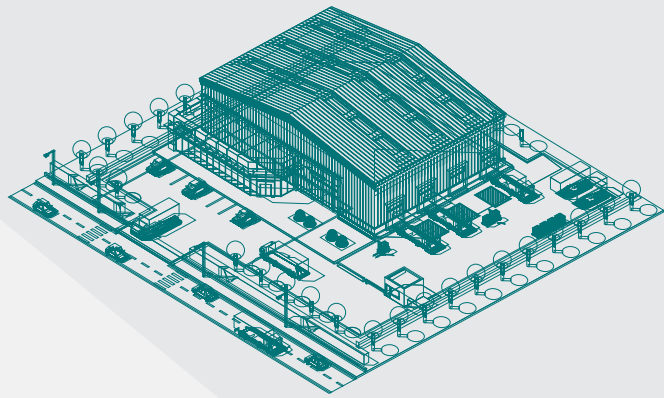

## Why Industrial Lands Matter

- Create local jobs & support a resilient economy
- Generate ~30% of Metro Vancouver's GDP
- Provide jobs with wages 14% above regional average
- Reduce commuting by keeping jobs local
- Strengthen City finances by diversifying tax base

## What Happens on Industrial Lands?

Industrial businesses need specialized space, access, & infrastructure to operate efficiently. They include:



**Manufacturing** (food, beverage, equipment, parts)



**Warehousing & Distribution**



**Emerging Sectors**  
(agri-tech, life sciences, advanced manufacturing, "maker" spaces)



**Construction**  
(materials, suppliers)



**Repair & Maintenance**  
(autobody, equipment)



**Maple Ridge**

[MapleRidge.ca/IndustrialLands](https://MapleRidge.ca/IndustrialLands)

# Industrial Lands

Business Growth. Local Jobs. Thriving Economy.

## Major Opportunity

Strong regional demand and a shortage of industrial land have created an opportunity for Maple Ridge, with key transport infrastructure nearby reducing truck travel and emissions.

## Strategic Positioning

- Workforce (58,000 workers)
- Access to 3.3 million people within 1 hour
- Competitive land costs
- Excellent transportation (road, rail, port access)

## Regional Growth Sectors

- Manufacturing and value-added production
- Food and agri-tech
- Construction and prefabrication
- Transportation, logistics, and cold storage
- Innovation and creative industries

## Future Planning

- Preparing land (roads, services, utilities)
- Phasing development responsibly
- Using funding tools like Development Cost Charges, grants, and partnerships
- Supporting businesses and delivering public benefits like parks, environmental protection, & transportation improvements



**Maple Ridge**

[MapleRidge.ca/IndustrialLands](https://MapleRidge.ca/IndustrialLands)