



PROPOSED PARK DEVELOPMENT

OPEN HOUSE - MAY 11th, 2017

Project Description

As envisioned in the Official Community Plan this proposed neighbourhood park is 1.47 hectares (3.64 acres). The existing site is characterized by mixed deciduous and coniferous forest in a low lying area, with a grassed open area sloping to the south. An existing gravel trail runs east/west through the site.

The Community Facilities Conversation, which is a separate process, is also exploring the concept of enhanced amenities in the Silver Valley area including gathering spaces and community gardens. Please see <http://www.mapleridge.ca/1676/Community-Facilities-Conversation> for more information.

The City proposes to develop the site into a neighbourhood park with input from the community on desired amenities.

Existing Conditions



View to east from 230 A St.



Looking east along the existing trail



View to north east





PROPOSED PARK DEVELOPMENT

NEIGHBOURHOOD CONTEXT

This park is located in the Blaney Hamlet neighbourhood of Silver Valley. Some of the nearby parks and trails include:

**Birch Park - Playground
Docksteader Trail**

**Future plans include:
Park at Nelsons Peak - Seating Plaza**

Nearby Park Amenities:

- Playground
- Seating Plaza (Future)
- Trails and Walkways
- Greenspace areas





PROPOSED PARK DEVELOPMENT

TYPICAL NEIGHBOURHOOD PARK AMENITIES

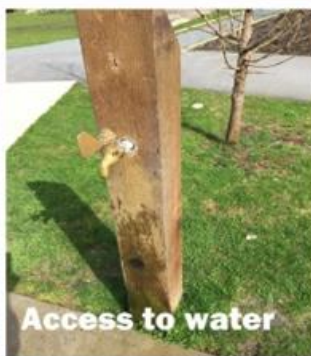



PROPOSED PARK DEVELOPMENT

EXISTING SITE PLAN

Legend

--- Property Line

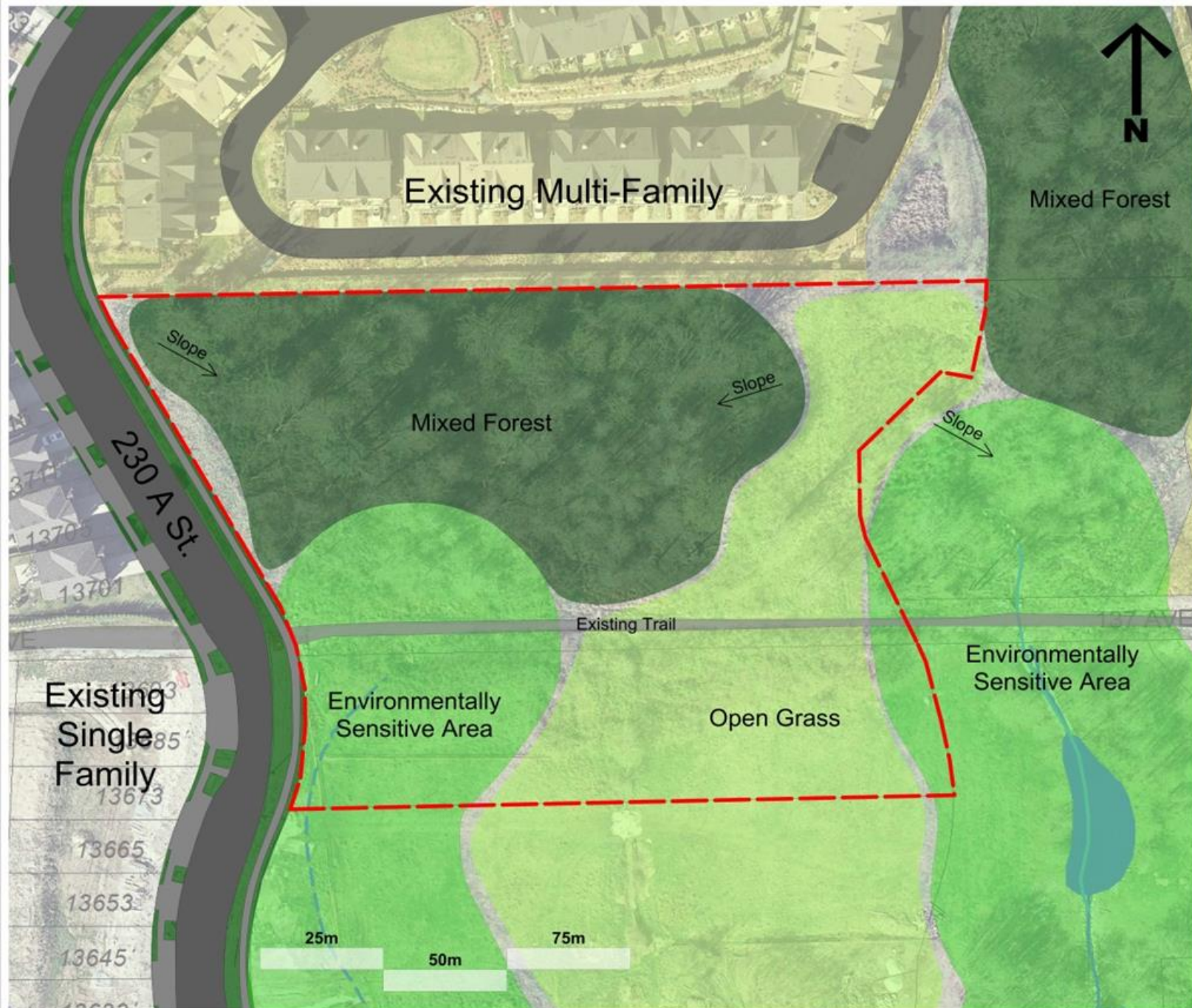



PROPOSED PARK DEVELOPMENT

Project Schedule

Phase 1: Public Engagement Open House May 11th, 2017 May 2017	Phase 2: Concept Plan Share with public June 2017	Phase 3: Detailed Design Design development Summer/Fall 2017	Phase 4: Park Construction Winter 2017
---	--	---	--



Share Your Comments

Please take a moment to share your comments and thoughts with us by completing one of our comment forms. Your comments will help us determine what amenities to include in the park concept plan. You can also take a comment form home and return it to the City by mail, email or in person.

Next Steps

The City will gather your comments over the next two weeks and then use this feedback to inform the conceptual design of the park. The park concept will be publicly shared at a later date with feedback sought. Check back at www.mapleridge.ca/1441/Park-Development-Projects for project updates.

www.mapleridge.ca/parksandrec



Explore our social channels
at /YourMapleRidge